

SNOW PROFESSIONAL SERIES

16.50 Gross Torque

342 CC

Bore 3.12 in. (79 mm)

Stroke 2.43 in. (61 mm)

Oil Capacity 26-28 fl. oz. (0.77 - 0.83 L)



Features:

- Kool Bore™ aluminum alloy bore for cooler operation
- Super Lo-Tone™ muffler for quiet operation
- Float carburetor for consistent easy starting
- Maintenance-free Magnetron® electronic ignition for quick, dependable starts
- Overhead valve design (OHV) for cooler operation and longer valve life
- Freeze-resistant recoil starter with oversized mitt-grip rewind handle
- Easy-start primer is easy-to-find and use for fast, reliable cold weather starting
- Buyer protection package provides two-year consumer engine warranty

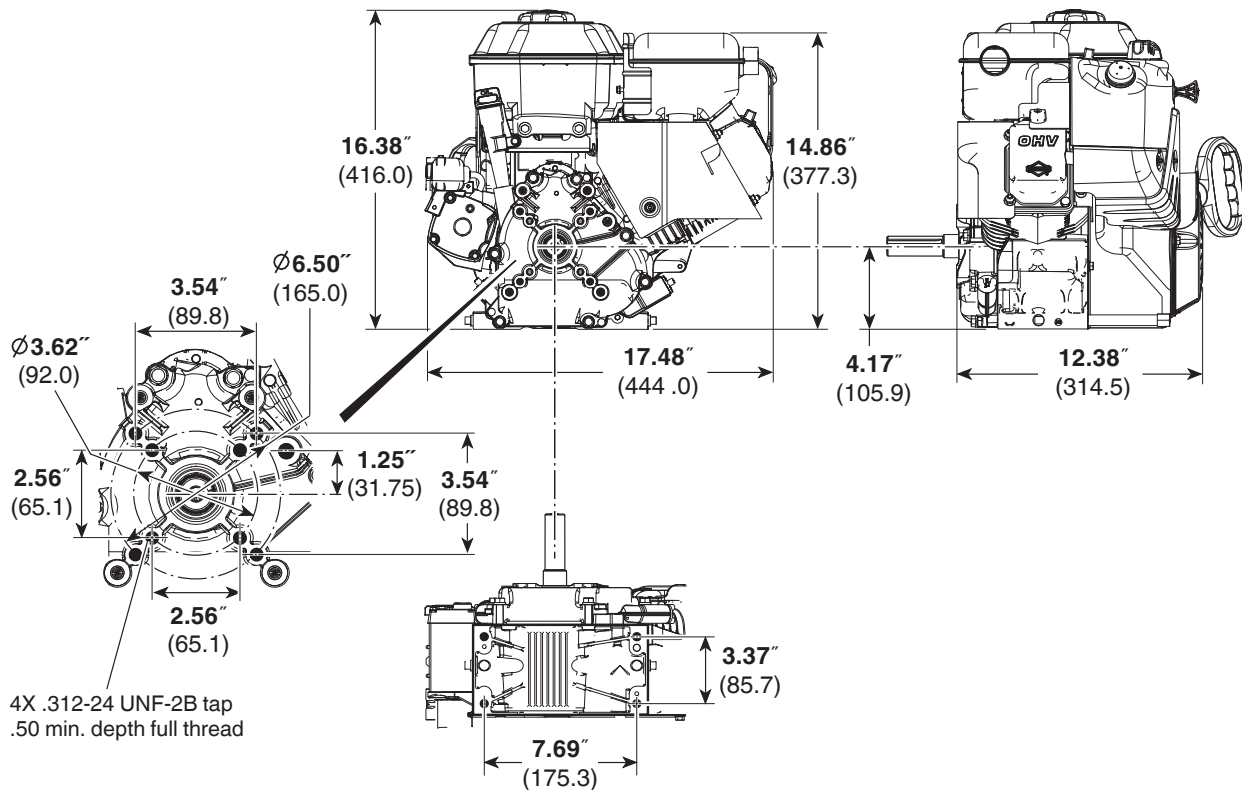

Model Type	Shipping Weight	Crankshaft	Crankshaft (P.T.O.) Extension	Dimension	Starter Position	Oil Filler & Drain	Governor	Controls	Manual Choke	Fuel Tank (Quarts)	Key Switch Stop	Flange Mtg.	Top Governor Speed	Notes
21M314														
3017	74	794720	3/4" dia., Keyway, tapped 3/8-24	2-33/64(c)	3	T	M	MF/R	X	3.2	X	X	3600	<input type="checkbox"/>
3019	74	794716	1" dia., Keyway, tapped 3/8-24	2-29/32(c)	3	T	M	MF/R	X	3.2	X	X	3600	<input type="checkbox"/>

110 Volt Gear Drive Starter with Dual Circuit Alternator (3 Amp DC - 14 Volts AC)