

# SNOW PROFESSIONAL SERIES

## 14.50 Gross Torque

## 305 CC

Bore 3.12 in. (79.0 mm)

Stroke 2.43 in. (61.0 mm)

Oil Capacity 26-28 fl. oz. (0.77 - 0.83 L)



### Features:

- Kool Bore™ aluminum alloy bore for cooler operation
- Super Lo-Tone™ muffler for quiet operation
- Float carburetor for consistent easy starting
- Maintenance-free Magnetron® electronic ignition for quick, dependable starts
- Overhead valve design (OHV) for cooler operation and longer valve life
- Freeze-resistant recoil starter with oversized mitt-grip rewind handle
- Easy-start primer is easy-to-find and use for fast, reliable cold weather starting
- Buyer protection package provides two-year consumer engine warranty

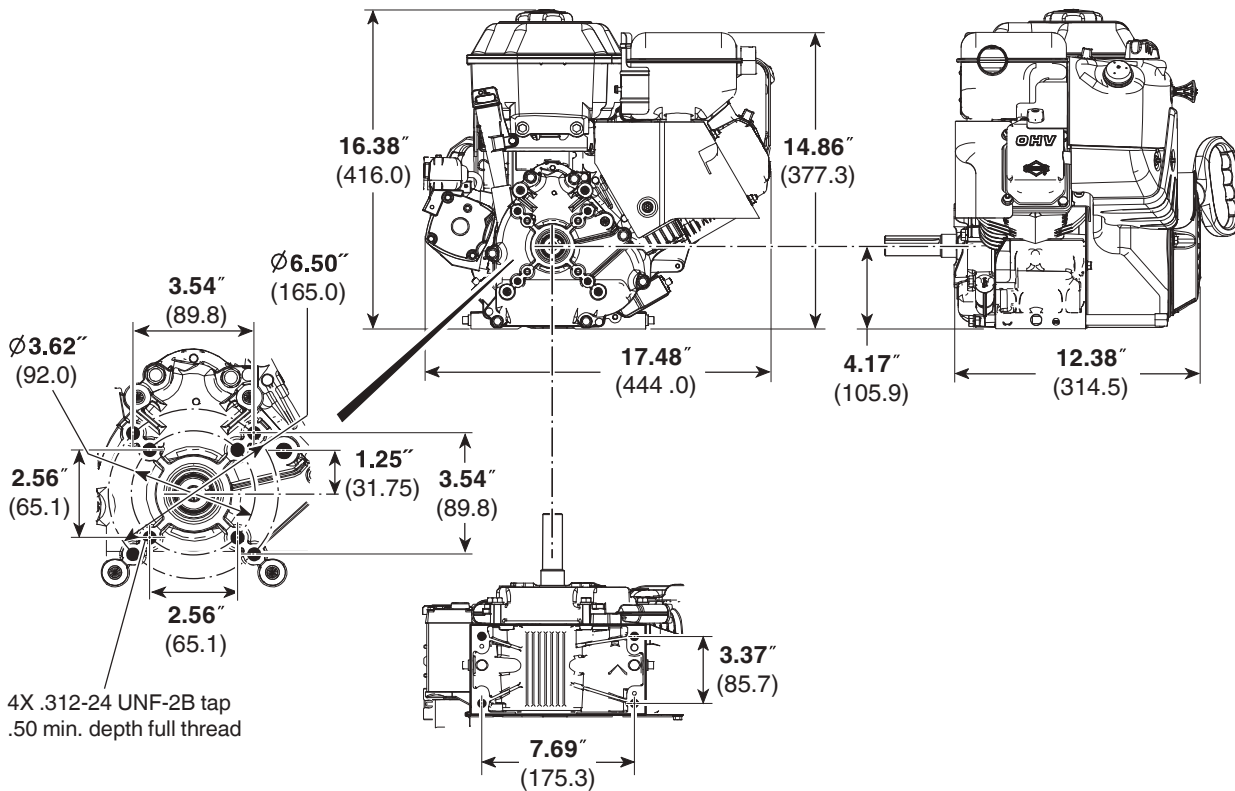

Model Type	Shipping Weight	Crankshaft	Crankshaft (P.T.O.) Extension	Dimension	Starter Position	Oil Filler & Drain	Governor	Controls	Manual Choke	Fuel Tank (Quarts)	Key Switch Stop	Flange Mtg.	Top Governor Speed	Notes
<b>20M312</b>														
3007	67	794717	1" dia., Keyway, tapped 7/16-20	3-21/32(c)	3	T	M	MF/R	X	3.2	X	X	3600	■
3009	66	794716	1" dia., Keyway, tapped 3/8-24	2-29/32(c)	3	T	M	MF/R	X	3.2	X	X	3600	■
<b>20M314</b>														
3017	74	794717	1" dia., Keyway, tapped 7/16-20	3-21/32(c)	3	T	M	MF/R	X	3.2	X	X	3600	□
3021	72	795079	1-7/8" Double Step, Keyway, tapped 3/8-24	2-7/8(c)	3	T	M	MF/R	X	3.2	X	X	3600	△

■ Engine equipped to receive 110 Volt Gear Drive Starter. □ Engine equipped with 110 Volt Gear Drive Starter with Dual Circuit Alternator (3 Amp DC - 14 Volts AC).

△ Engine equipped with 110 Volt Gear Drive Starter and Dual Circuit Alternator (3 AMP DC - 60W AC).