

2.4 HP VANGUARD™ Model Series 50000

Displacement 4.88 cu. in. (80 cc)

Bore 2.05 in. (52 mm)

Stroke 1.49 in. (38 mm)

Oil Capacity 13.5 fl. oz. (.4 l)



COMMERCIAL POWER



Features:

- Dura-Bore™ cast iron cylinder sleeve for extended life
- Float carburetor for consistent easy starting
- Maintenance-free Magnetron® electronic ignition for quick, dependable starts
- Dual-Clean™ air cleaner pleated paper filter with a foam pre-cleaner ensures maximum protection for extended engine life
- Oil Gard® low oil engine shutdown device
- Overhead valve design (OHV) for cooler operation and longer valve life
- Buyer protection package provides two-year commercial engine warranty

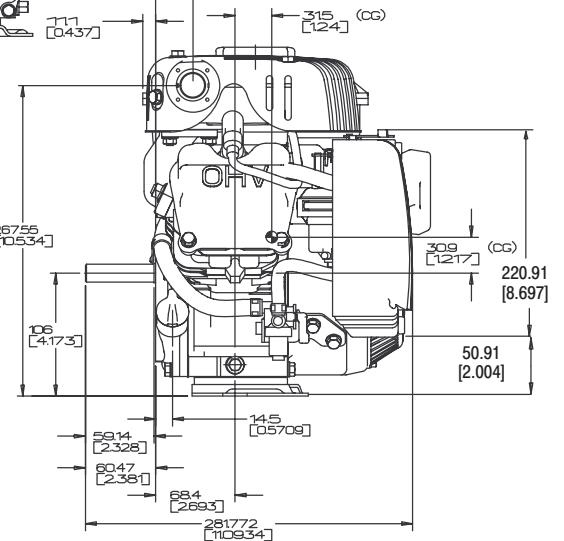
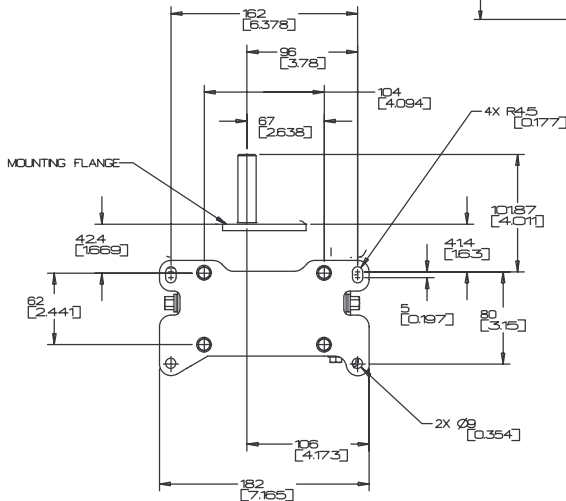
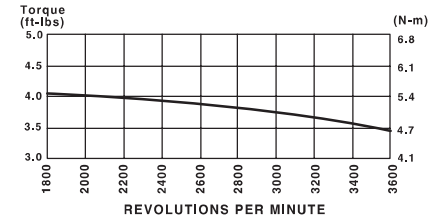
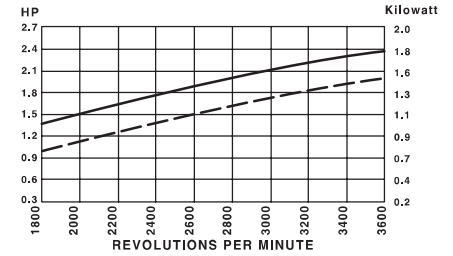
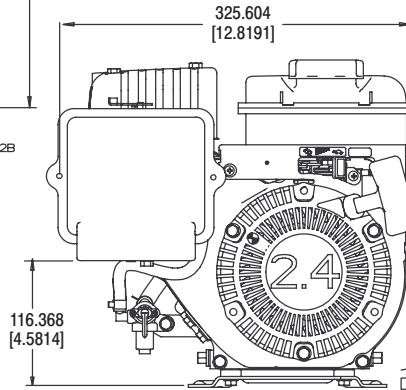
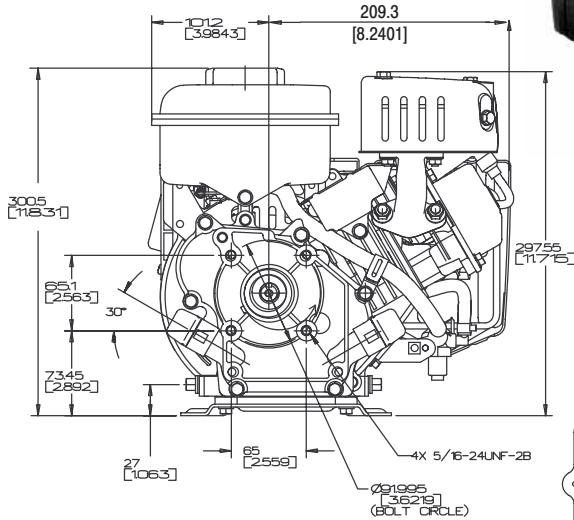

Model Type	Shipping Weight	Crankshaft	Crankshaft (P.T.O.) Extension	Dimension	Starter Position	Bolt-On/Changeable	Oil Filler & Drain	Governor	Controls	Manual Choke	Fuel Tank (Quarts)	Rocker Stop Switch	Oil Gard®	Flange Mtg.	Top Governor Speed	Notes
50032																
0005	28	715923	5/8" dia., Keyway, tapped 1/4-28	2-3/8(c)	2	D	M	R/AG/MF	X	1.7	X	X	X	X	3600	•
0006	28	715923	5/8" dia., Keyway, tapped 1/4-28	2-3/8(c)	2	D	M	R/AG/MF	X	1.7	X	X	X	X	3600	▽•

• Ball bearing PTO and magneto side ▽ Square dual air cleaner