

CH395 3 Amp Key Box Conversion Kit 17 755 84-S CH440 3 Amp Key Box Conversion Kit 17 755 66-S

This kit contains the parts needed to convert from the old style key box to the latest version.

	<p>⚠ WARNING</p> <p>Accidental Starts can cause severe injury or death. Disconnect and ground spark plug lead(s) before servicing.</p>	<p>Before working on engine or equipment, disable engine as follows: 1) Disconnect spark plug lead(s). 2) Disconnect negative (-) battery cable from battery.</p>
--	---	---

This Kit Contains –

Qty.	Description
1	Clamp, Insulated
1	Screw, Hex/Phillips M5
1	Harness, Wiring Assembly (3 Amp)
1	Key Box
1	Cover, Key box
1	Control, Oil Alert Unit
1	Wire Tie
1	Installation Instruction

To Install –

NOTE: These instructions cover installation of kit components only.

1. Disconnect wires and remove the old key box from engine and save hardware.
2. Slide the new harness (A) thru the key box cover (B). See Figure 1.

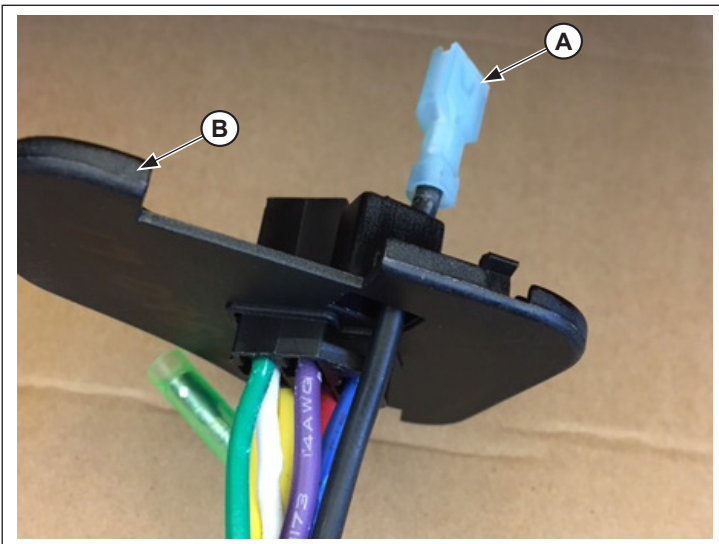

Figure 1. Insert New Harness.

3. Attach the new harness (A) to the new key box. Snap the cover (B) onto the new key box. See Figure 2.

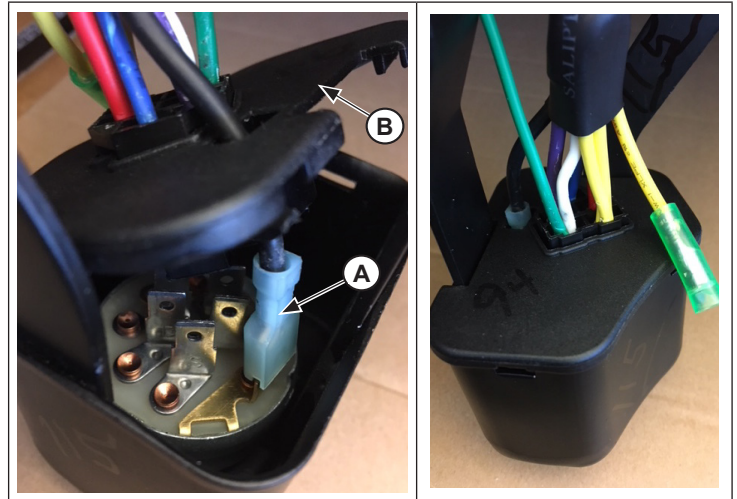

Figure 2. Attach New Harness to New Key Box.

4. Mount the new key box. See Figure 3.

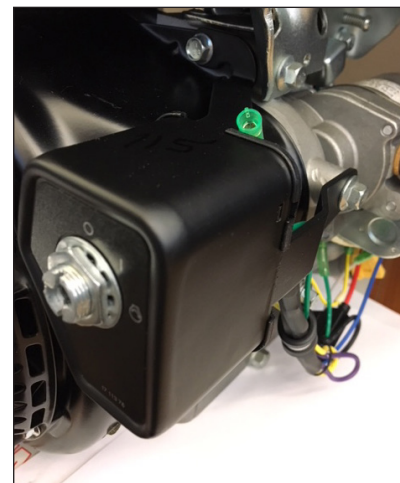

Figure 3. Mount New Key Box.

5. Connect key box white lead to ignition lead routed under fuel tank.
6. Connect key box red lead (C) to starter solenoid using nut and two washers removed in step 1. See Figure 4.
7. Connect key box blue lead (D) to starter solenoid blade terminal. See Figure 4.

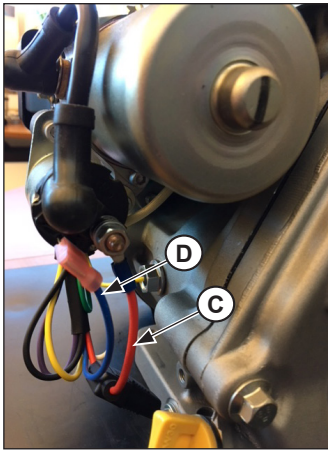

Figure 4. Connect Key Box Leads to Starter Solenoid.

8. Key box yellow lead is not used in this conversion.
9. Attach key box green wire (E) to new oil alert control (F) and connect other lead (G) of control to oil level switch lead (H) coming out of crankcase. See Figure 5.

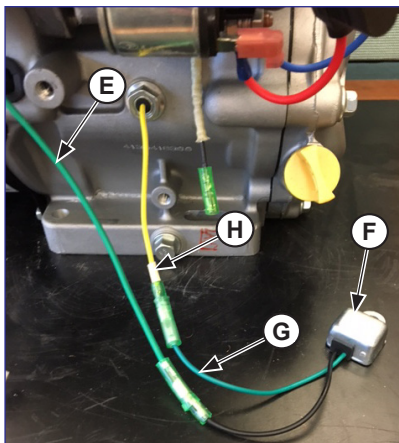

Figure 5. Connect Key Box Lead to Oil Alert Control.

10. Mount new oil alert control (F) above starter with new screw, routing wires behind starter. See Figure 6.

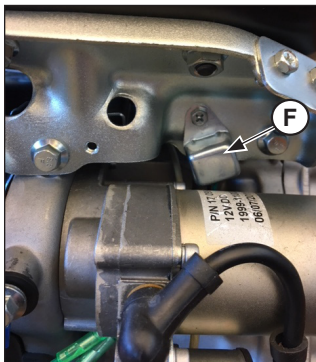

Figure 6. Mount New Oil Alert Control.

11. Connect key box purple lead (I) to female bullet connector on stator lead. See Figure 7.

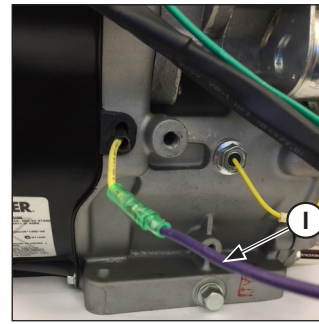

Figure 7. Connect Key Box Purple Lead to Stator Lead.

12. Wrap new clamp (J) around wires and attach clamp and key box black wire to crankcase with bolt removed in step 1. See Figure 8.

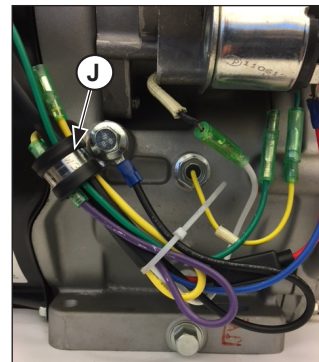

Figure 8. Install New Clamp.

13. Secure wires with wire tie (K). See Figure 9.

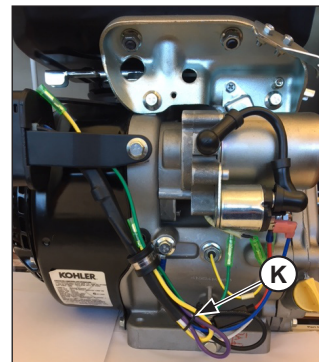

Figure 9. Secure All Wires with Wire Tie.